

HYBRID STEPPING MOTOR SPECIFICATION

DIMENSIONS unit=mm

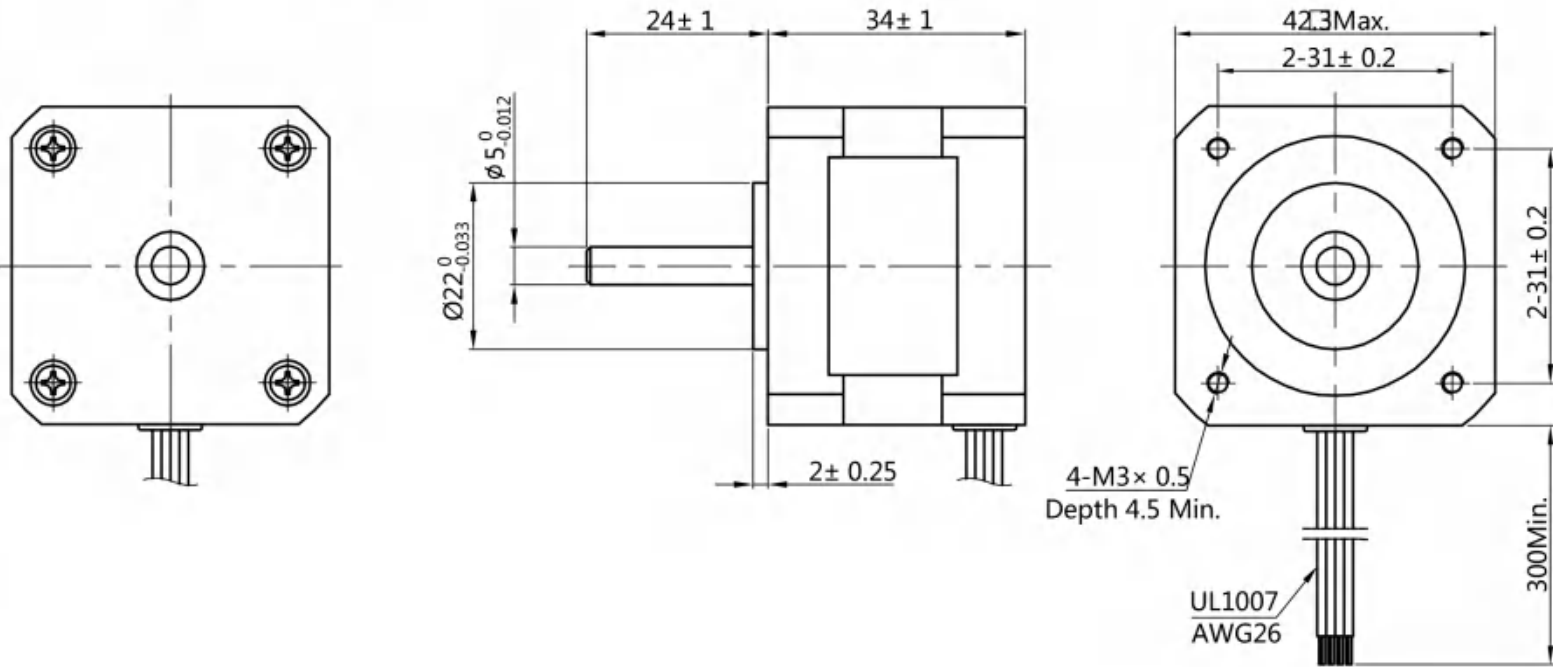

Wiring Diagram

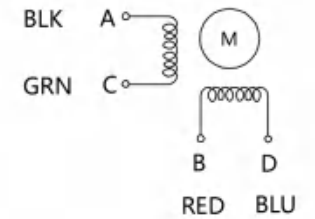

Exciting Sequence vs. Direction of Rotation

STEP	A	B	C	D	
1	+	+	-	-	CW ↓ CCW ↑
2	-	+	+	-	
3	-	-	+	+	
4	+	-	-	+	

Clockwise view from mounting side

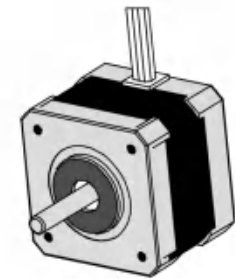

1. Number of Phase	2				
2. Step Angle	0.9° deg.				
3. Rated Voltage	2.79 V				
4. Rated Current/Phase	1.33 A (Peak Value)				
5. Phase Resistance	2.1 Ω ± 0.1(20°C)				
6. Phase Inductance	4.2 mH± 20%(1kHz 1V RMS)				
7. Holding Torque	2.2 kg.cm				
8. Insulation Class	B (130°); 80K Max.				
9. Weight	0.22 kg				
Specifications		Comment			

REV.	REVISION RECORD		DATE
DESIGN	2020.6.29	Changzhou BesFoc Motor Co., Ltd www.besfoc.com	
STANDARD		Specification	
TECHNOLOGY			
CHECK			
APPROVE			

TITLE	STEPPING MOTOR			
DWG.NO.	BF42HM34-1334			
MATERIAL	ECN SIGN	✳	SIZE	A4
REV.	A	SCALE	1:2	SHEET 1 of 1